

## Technical specifications DCNEO-A-F120-1



250V16A, type 2  
vehicle inlet, be used for AC charging  
interface charging of European standard  
electric vehicle.

### Product description

Used for AC charging interface charging of European standard electric vehicle

### Advantages

- ✓ Streamlined design with beautiful appearance
- ✓ The contacts of power terminal and signal terminal are silver plated
- ✓ Enterprise has passed ISO 9001:2015
- ✓ The product has passed CE certification and its performance is safe and reliable.
- ✓ Multiple seal structure design, excellent waterproof performance
- ✓ Products are available in many colors and can be customized according to requirements

### Technical parameter

#### Product definition

Product type	Charging cable with type 2 vehicle inlet
Type	N/A
Standards / procedures	IEC62196-2014
	IEC61851-2017
Voltage type	AC
Charging mode/case type	Mode 3,

#### Size

Length of vehicle inlet	162mm
Width of vehicle inlet	117mm
Height of vehicle inlet	117mm
Cable length	N/A

## Technical parameter

### Size

Length of Control box	N/A
Width of Control box	N/A
Height of Control box	N/A
Cable length	N/A

### Environment condition

Ambient temperature (operation)	-30 °C ..... 50 °C
Ambient temperature (storage / transportation)	-40 °C ..... 80
Maximum altitude	2000m
IP code	IP54 (Unmated)
	IP55(Mated)

### Electrical characteristics

Charging power	4kW
Phase number	Single-phase
Number of power pins	3pcs(L1,N, PE)
Rated current of high power contact	16A
Rated voltage of power contact	250 V AC
Number of signal contacts	2pcs (CP, PP)
Rated current of signal contact	2 A
Rated voltage of signal contact	30 V AC
Signal transmission type	PWM
Precautions in connection method	Crimp connection, do not disconnect
R6 resistance	-
R7 resistance	-
RC resistance	680Ω

### Mechanical properties

Insertion / extraction times	> 10000
Insertion force	< 80N
Pull-out force	< 80N

### Structural characteristics

Shell color	Black
Insulator color	Black
Contact color	silvery
Cover color	Black
Customized type	According to customer requirements

## Technical parameter

### Material

Shell material	Plastic
Contact material	Copper
Seal material	rubber
Insulator material	Plastic
Flame retardant grade	V0
Contact surface material	Ag

### Cable (if have)

Cable structure	3 x 2.5mm <sup>2</sup> + 2 x 0.5mm <sup>2</sup>
Wiring standards / specifications	IEC 61851-2017
Wiring authentication	UL/TUV
Cable outer diameter	N/A
Cable Type	Straight type
Outer sheath, material	TPE
Outer jacket, color	Black / orange(Reference )
Minimum bending radius	15 x diameter(Reference )

### Locking device

Locking type	Electronic locking(Reference )
--------------	--------------------------------

### Environmental protection requirements

REACH SVHC	Lead 7439-92-1
China RoHS	Environmental protection service life= 10;

## Product drawing

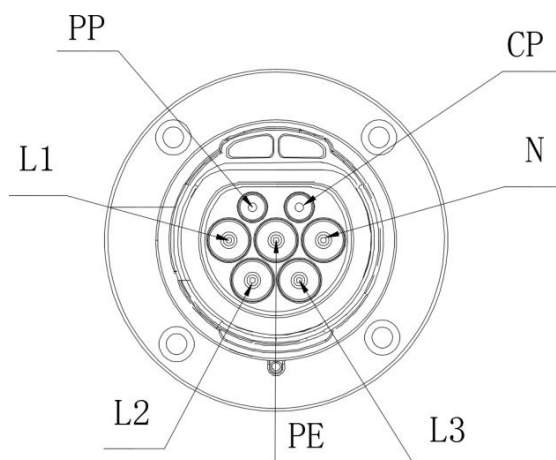

Layout of type 2 vehicle connector pins

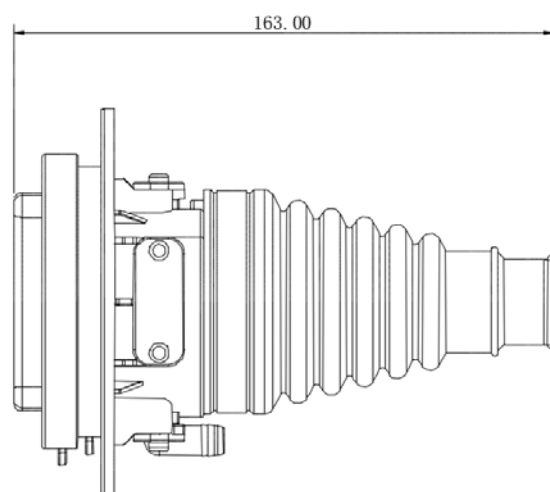
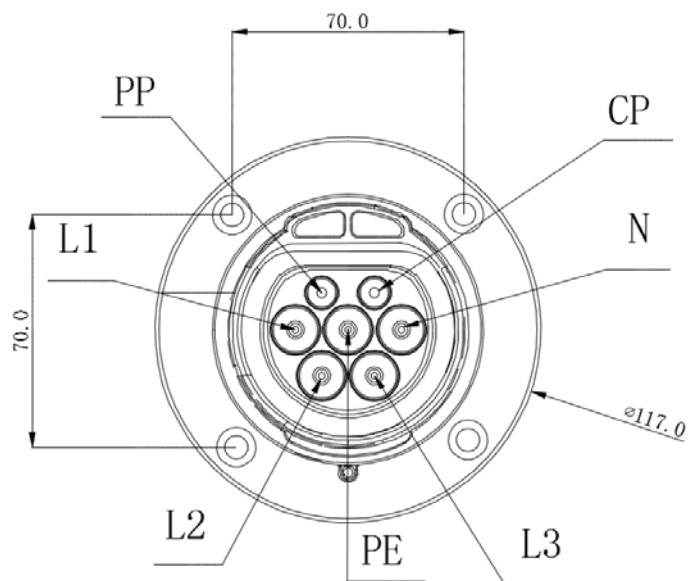

charging cable with type 2 vehicle inlet

## Operation guide

### Recommended opening size

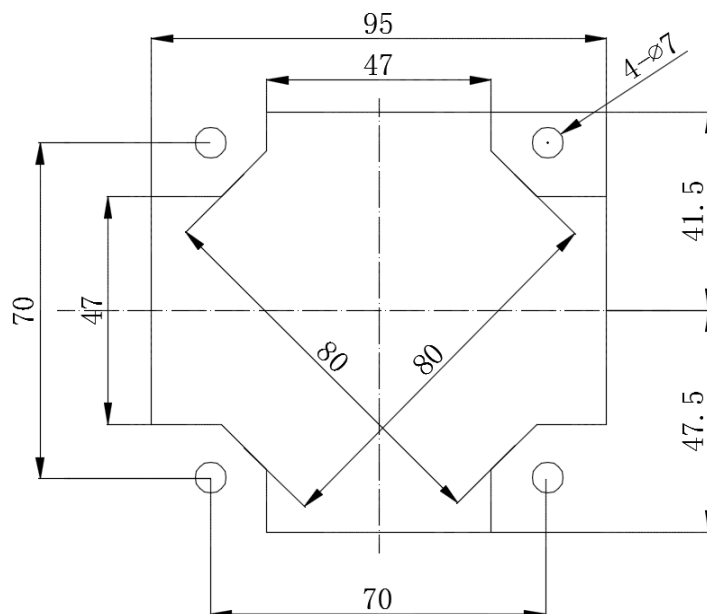

## Installation diagram

---

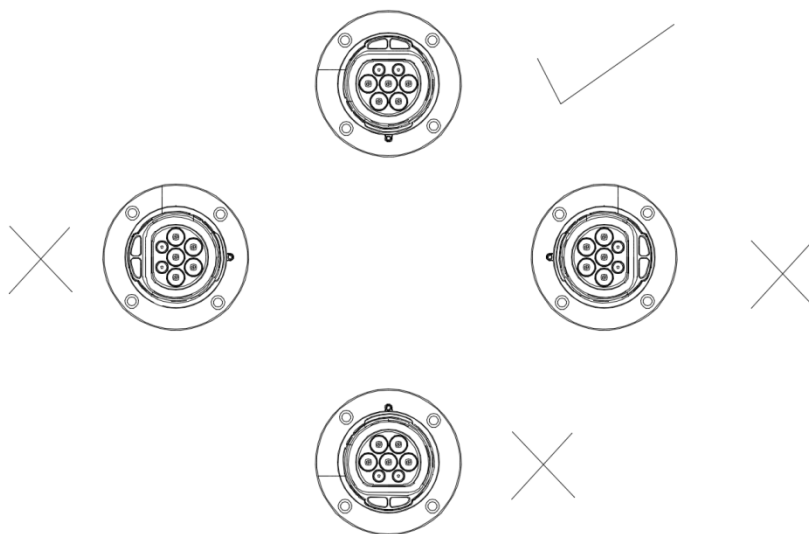

## Enclosure (Optional, see the corresponding specifications for details)

---

TYPE 2 Vehicle Connector



Used in charging post or charging station, fixed charging vehicle inlet